

# SANDING

Pneumatic Belt Sander

## BELTON

*Ideal for sanding and grinding in narrow spaces, recessed areas and on curved surfaces*

- Quick belt change
- Rear exhaust system

### Model **B-10CL**

- Belt size 10 mm (W)

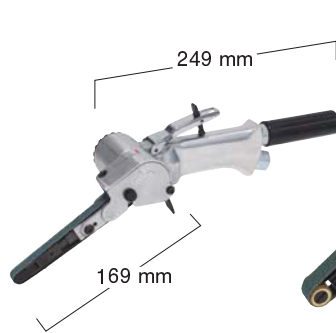

### Model **B-20CL**

- Belt size 20 mm (W)

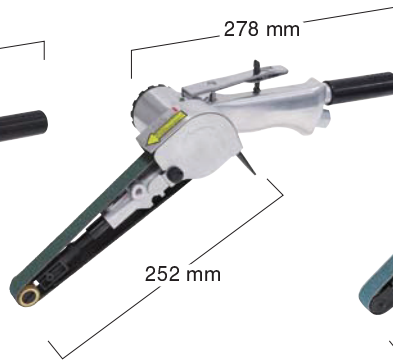

The Idle Pulley for B-20CL is supported on one side only.



### Model **B-20CL-A**

- Belt size 20 mm (W)

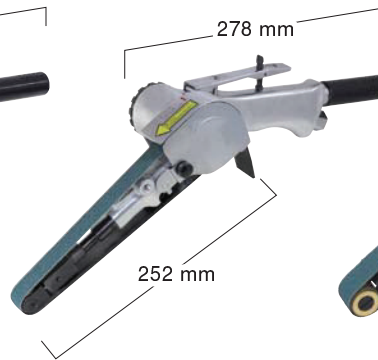

The Idle Pulley for B-20CL-A is supported on both sides.



### Model **B-30CL**

- Belt size 30 mm (W)



### Specifications

Model	B-10CL	B-20CL	B-20CL-A	B-30CL	
Air Pressure	MPa (kgf/cm <sup>2</sup> )		0.6 (6)		
Air Consumption (No-load)	m <sup>3</sup> /min	0.4	0.48	0.82	
Free Speed	min <sup>-1</sup> (rpm)	17000	18000	15000	
Belt Speed	m/min	1120	2770	2310	
Belt Size	mm	10 x 330	20 x 520	30 x 540	
Inlet Size			Rc 1/4		
Mass (Weight)	kg	0.9	1.6	1.5	2.4
Accessories Included	<ul style="list-style-type: none"> <li>• 2 pieces of Abrasive Belt Z#60 x 10 mm (1 piece installed)</li> <li>• Abrasive Belt Z#80 x 10 mm</li> <li>• Abrasive Belt Z#100 x 10 mm</li> <li>• Abrasive Belt Z#120 x 10 mm</li> <li>• 1.5 mm Hex. Socket Screw Key</li> <li>• 4 mm Hex. Socket Screw Key</li> <li>• Bushing R 1/4 x NPT 1/4</li> </ul>	<ul style="list-style-type: none"> <li>• 2 pieces of Abrasive Belt Z#60 x 20 mm (1 piece installed)</li> <li>• Abrasive Belt Z#80 x 20 mm</li> <li>• Abrasive Belt Z#100 x 20 mm</li> <li>• Abrasive Belt Z#120 x 20 mm</li> <li>• 2.5 mm Hex. Socket Screw Key</li> <li>• 4 mm Hex. Socket Screw Key</li> <li>• Bushing R 1/4 x NPT 1/4</li> <li>• Convex Shoe</li> </ul>	<ul style="list-style-type: none"> <li>• 2 pieces of Abrasive Belt Z#60 x 30 mm (1 piece installed)</li> <li>• Abrasive Belt Z#80 x 30 mm</li> <li>• Abrasive Belt Z#100 x 30 mm</li> <li>• 5 mm Hex. Socket Screw Key</li> <li>• Handle Assy</li> <li>• Bushing R 1/4 x NPT 1/4</li> </ul>		

### Easy belt change

Abrasive belt can be changed easily. \*Rotate and open the cover when changing.

#### Self-locking

Push the idle pulley into self-lock position to loosen the belt.

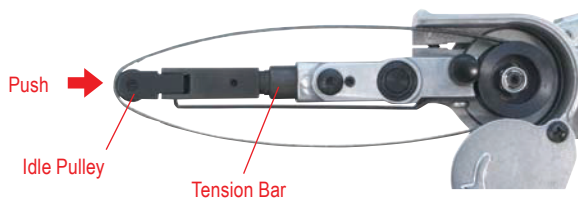

For all models

#### Unlock

Press the push button to pull back the tension bar.

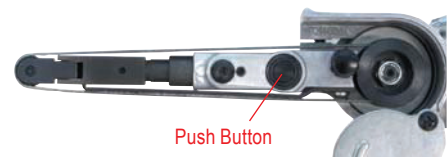

10/20 Type

Press the shoe in the direction of the arrow.

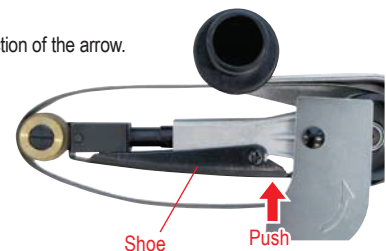

30 Type

# SANDING

## Adjustable angle for efficient operation

Guard angle can be changed freely in accordance with the working position and shape of the workpiece.

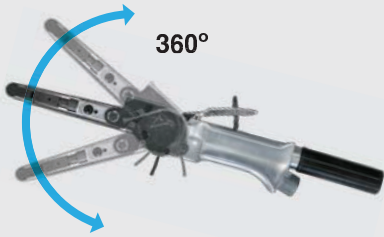

## Belt Speed Adjustment

Belt speed can be easily adjusted by turning the adjust valve with a screwdriver.

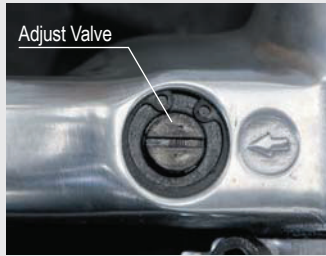

## Curved surface grinding

Curved surface grinding is possible by using the Offset Bracket (Optional).

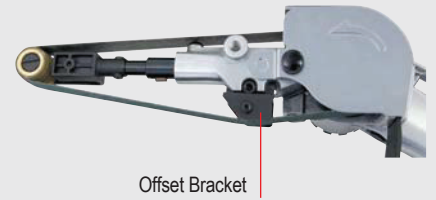



## Abrasive Belt for B-10CL

Belt Size : 6 mm x 330 mm (W x L)

Grit	PN	
	Zirconia (Z)	Alumina (AA)
#40	-	-
#60	TB00241	-
#80	TB00242	-
#100	TB00243	-
#120	TB00244	-
#180	TB00245	-
#240	TB00246	-
#400	-	TA9A237
Sales Unit	 50 pcs./set When using the belt, optional Bracket 6 Ass'y and Shoe 6 are required. (Ref. No.5, 6)	



## Abrasive Belt for B-10CL

Belt Size : 10 mm x 330 mm (W x L)

Grit	PN		
	Zirconia (Z)	Alumina (AA)	Ceramic (CE)
#40	-	-	TB08368
#60	TA9A064	-	TB08369
#80	TB00076	-	TB08370
#100	TB00077	-	TB08371
#120	TB00247	-	TB08372
#180	TB00248	-	-
#240	TB00249	-	-
#400	-	TA9A244	-
Sales Unit	 50 pcs./set	 50 pcs./set	



## Abrasive Belt for B-20CL, B-20CL-A

Belt Size : 20 mm x 520 mm (W x L)

Grit	PN		
	Zirconia (Z)	Alumina (AA)	Ceramic (CE)
#40	TA99605	-	TB08373
#60	TA99606	-	TB08374
#80	TA99607	-	TB08375
#100	TA99608	-	TB08376
#120	TA99609	-	TB08377
#180	TB00250	-	-
#240	TB00251	-	-
#320	-	TA9A253	-
#400	-	TA9A254	-
Sales Unit	 20 pcs./set	 20 pcs./set	

## Abrasive Belt for B-30CL

Belt Size : 30 mm x 540 mm (W x L)

Grit	PN		
	Zirconia (Z)	Alumina (AA)	Ceramic (CE)
#40	TB00252	-	TB08378
#60	TB00253	-	TB08379
#80	TB00254	-	TB08380
#100	TB00255	-	TB08381
#120	TB00256	-	TB08382
#180	TB00257	-	-
#240	TB00258	-	-
#320	-	TA9A263	-
#400	-	TA9A264	-
Sales Unit	 20 pcs./set	 20 pcs./set	

## Optional Parts

Ref. No.	PN	Description	Sales Unit	Applicable Model		
				B-10CL	B-20CL B-20CL-A	B-30CL
1	TB09997	Offset Bracket 10 Ass'y	1 set	●		
2	TB10192	Offset Bracket 20 Ass'y	1 set		●	
3	TB08150	Offset Bracket 30 Ass'y	1 set			●
4	TB09938	Finger Pad Ass'y	1 set		●	
5	TB09996	Bracket 6 Ass'y	1 set	●		
6	TP14770	Shoe 6	1 piece	●		
7	TB10191	Convex Shoe	1 piece		●	



\* for Abrasive belt width 6 mm



# SANDING

Pneumatic Belt Sander

## BABY BELTON

*Ideal for deburring, chamfering, bead grinding, and polishing applications*

- Compact and lightweight, yet powerful
- Alternative rotation direction
- Ergonomically designed for left or right hand operator convenience

### Model **BB-10A**

- Lever switch type
- Belt size 10 mm (W)

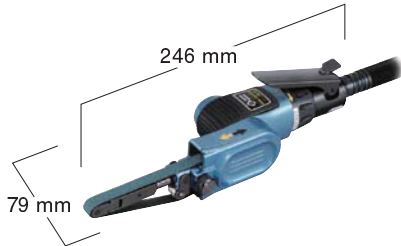

### Model **BB-10A** Non-CE

- Ring switch type
- Belt size 10 mm (W)



### Model **BB-20**

- Belt size 20 mm (W)

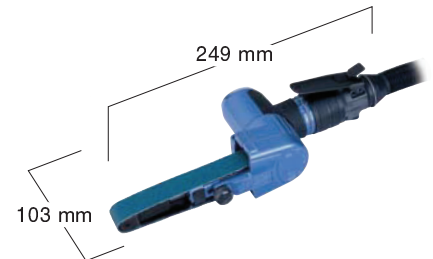

### Specifications

Model	BB-10A Lever Type	BB-10A Ring Type	BB-20
<b>Air Pressure</b>	MPa (kgf/cm <sup>2</sup> )	0.6 (6)	
<b>Air Consumption (No-load)</b>	m <sup>3</sup> /min	0.25	0.43
<b>Free Speed</b>	min <sup>-1</sup> (rpm)	16000	
<b>Belt Speed</b>	m/min	1000	1100
<b>Belt Size</b>	mm	10 x 330	20 x 330
<b>Inlet Size</b>		Rc 1/4	
<b>Mass (Weight)</b>	kg	0.6	0.8
<b>Accessories Included</b>	<ul style="list-style-type: none"> <li>• Abrasive Belt Z#100 x 10 mm (Installed)</li> <li>• Abrasive Belt Z#120 x 10 mm</li> <li>• Abrasive Belt Z#180 x 10 mm</li> <li>• Abrasive Belt Z#240 x 10 mm</li> <li>• 1.5 mm Hex. Socket Screw Key</li> <li>• Bushing R 1/4 x NPT 1/4</li> </ul>	<ul style="list-style-type: none"> <li>• Abrasive Belt Z#100 x 10 mm (Installed)</li> <li>• Abrasive Belt Z#120 x 10 mm</li> <li>• Abrasive Belt Z#180 x 10 mm</li> <li>• Abrasive Belt Z#240 x 10 mm</li> <li>• 1.5 mm Hex. Socket Screw Key</li> <li>• Bushing R 1/4 x NPT 1/4</li> </ul>	<ul style="list-style-type: none"> <li>• Abrasive Belt Z#60 x 20 mm (Installed)</li> <li>• Abrasive Belt Z#120 x 20 mm</li> <li>• Abrasive Belt Z#240 x 20 mm</li> <li>• 2.5 mm Hex. Socket Screw Key</li> <li>• 3 mm Hex. Socket Screw Key</li> <li>• Shoe</li> <li>• Dust Cover</li> <li>• Bushing R 1/4 x NPT 1/4</li> </ul>

### Quick and easy belt installation and removal "NO Tools Required"



### The throttle lever can be turned by 180 degrees.

Ergonomically designed for right or left hand operator convenience



### Belt rotation direction can be changed.

Belt rotation direction can be changed to control the direction of chip splash.

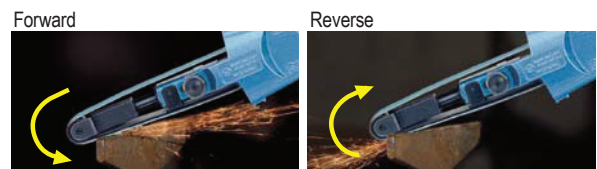

### Sanding for curved surfaces

Curved surface sanding is possible by using the offset bracket.

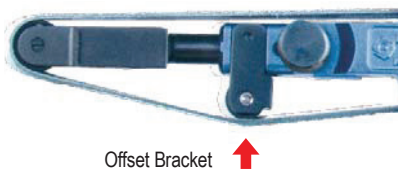

### The offset bracket can be positioned up or down.

Push-in offset bracket pulley allows the following use.

